

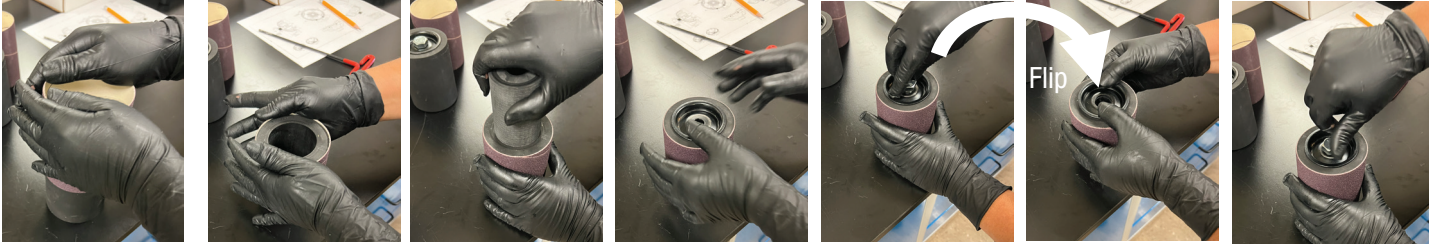

704-RETRO Instructions

How to prepare the drum for installation



To install a sanding sleeve you must remove the inner core of the drum.
Remove inner core of sanding drum by **loosening large set screw and removing the end caps.**
Slide desired sanding sleeve over the drum.
Reinstall the inner core of the sanding drum.
Attach end cap and insert the large set screw.
Flip the drum over and install the other cap and tighten with nut.

Installing the 704-RETRO Kit to your Sani-Grinder

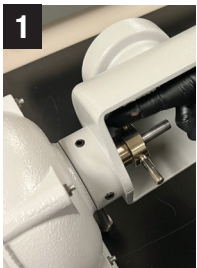

1
Unplug machine and **remove 4" flexihose** from the rear of the drum housing. Then **Remove 3" sanding drum** unscrewing the 3 prong nickel plated throw off, and unscrew completely.

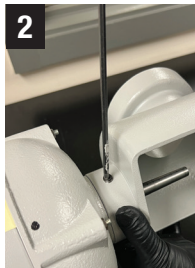

2
Remove old drum housing using an Allen key (5/32).



3
Reinstall new drum housing so the 4" opening is directly in the rear.

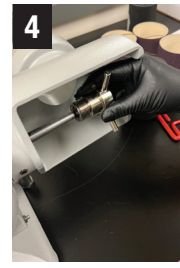

4
Reattach 4" flexihose, then **screw in the throw off** completely without overtightening.

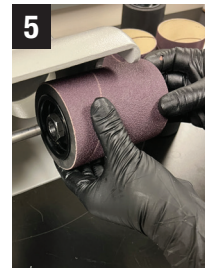

5
Slide 4" rubber drum with sanding sleeve over shaft. Tap on gently to ensure it is fully secure. **Plug machine in** and it is now ready for use



HANDLER

